

REAR RACK EXTENDER KIT



P/N 2884841

BEFORE YOU BEGIN

Read these instructions and check to be sure all parts and tools are accounted for. Please retain these installation instructions for future reference and parts ordering information.

APPLICATION

Verify accessory fitment at www.polaris.com.

KIT CONTENTS

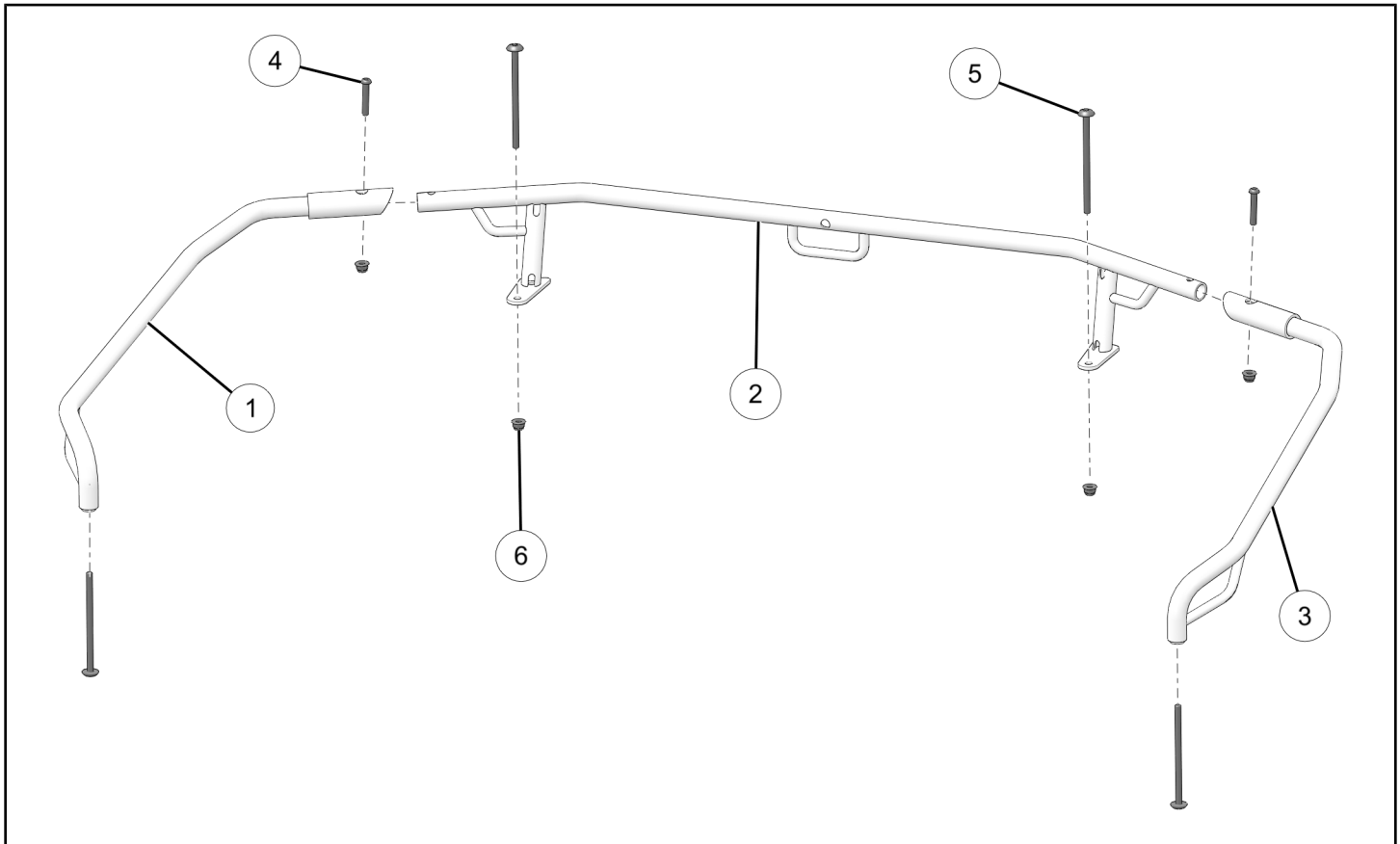

REF	QTY	PART DESCRIPTION	P/N AVAILABLE SEPARATELY	AVAILABLE SERVICE KIT
1	1	Rear Rack Extender, Right	1026089	n/a
2	1	Rear Rack Extender, Middle	1026090	n/a
3	1	Rear Rack Extender, Left	1026088	n/a
4	2	Screw - Socket Button Head, M6 x 1 x 35	n/a	2208773
5	4	Screw - Torx® Pan Head, M6 x 1 x 10.5	n/a	2208773
6	4	Nut - Hex Flange, M6 x 1	n/a	2208773

TOOLS REQUIRED

- Safety Glasses
- Socket Set, Metric
- Socket Set, Torx® Bit
- Torque Wrench
- Wrench Set, Metric

IMPORTANT

Your Rear Rack Extender Kit is exclusively designed for your vehicle. Please read the installation instructions thoroughly before beginning. Installation is easier if the vehicle is clean and free of debris. For your safety, and to ensure a satisfactory installation, perform all installation steps correctly in the sequence shown.

INSTALLATION INSTRUCTIONS

VEHICLE PREPARATION

GENERAL

1. Park vehicle on a flat surface.
2. Push engine stop switch to the OFF position.
3. Turn key to the OFF position and remove key.

ACCESSORY INSTALLATION

REAR RACK EXTENDER ASSEMBLY

1. Put ends of middle section ② into left section ③ and right section ①. Loosely install two screws ④ and two nuts ⑥.

Do not torque fasteners at this time.

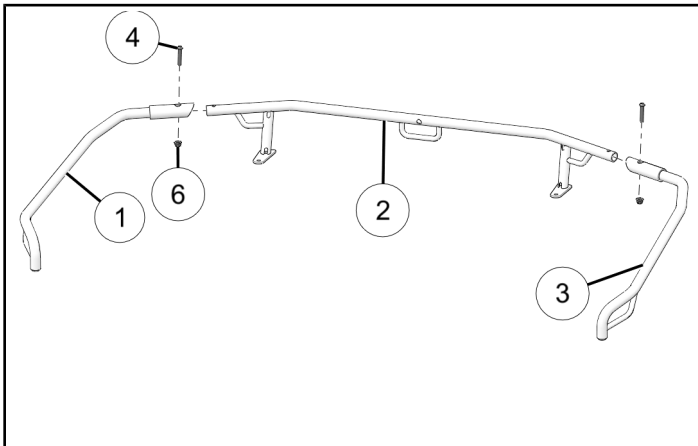

REAR RACK EXTENDER INSTALLATION

1. Remove and discard four screws from rear box cover.

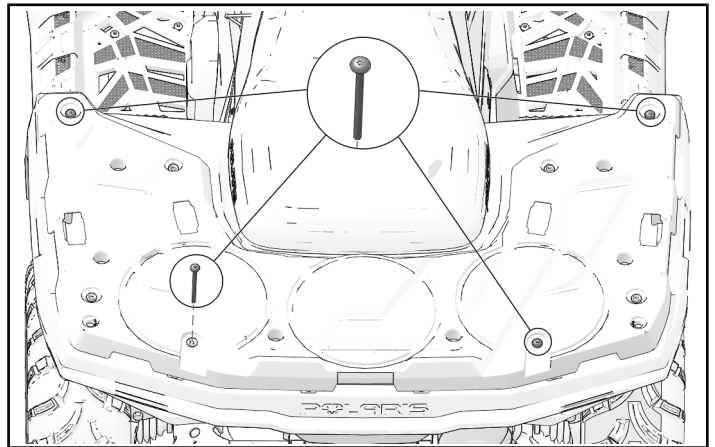

2. If equipped with dual tail lamps, unscrew the tail light shield on the right side and move shield aside.

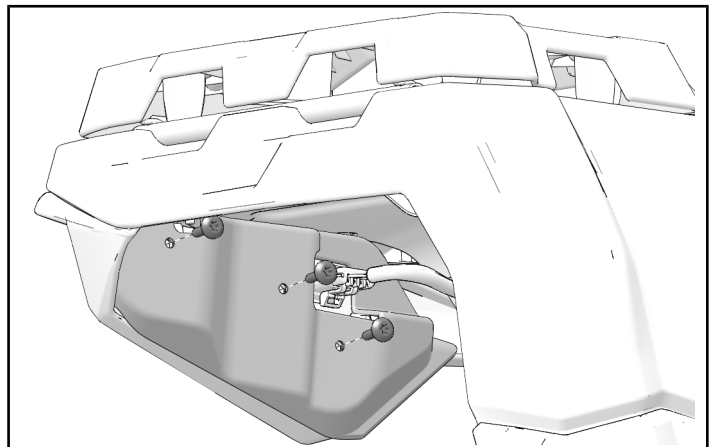

3. Align rear rack extender on rear box cover.

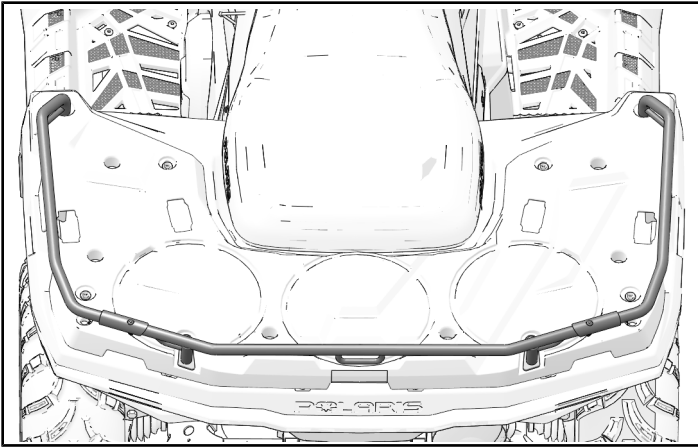

4. Install screw ⑤ from the underside of box cover up into rear rack extender. Repeat other side. Torque screws to specification.

TORQUE

Rear Rack Underside Screw ⑤:
84 in-lbs (9 N·m)

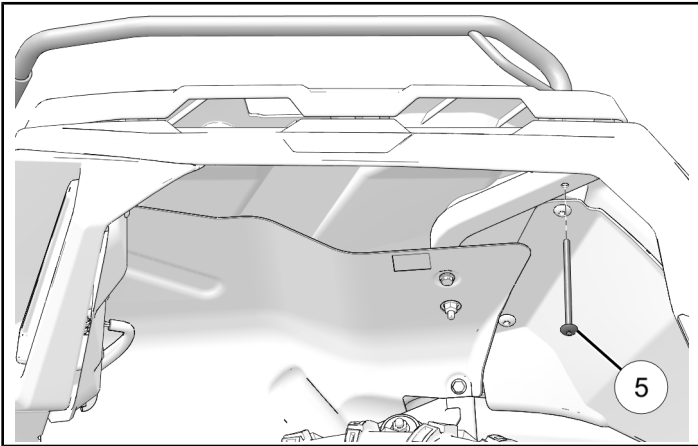

5. Install two screws ⑤ through the rear rack extender down through the box cover.

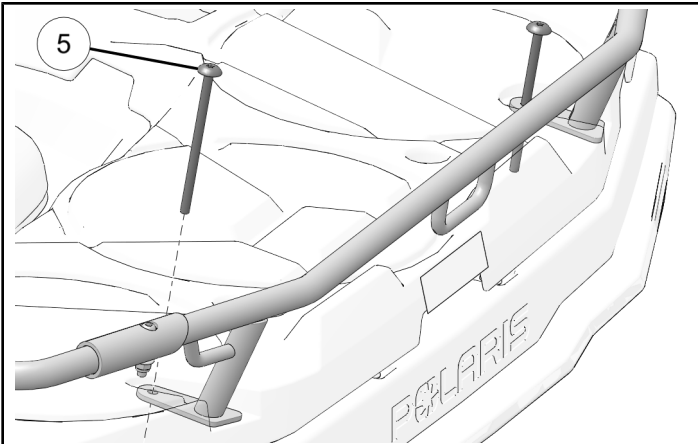

6. Install nut ⑥ onto screw ⑤. Repeat other side. Torque screws to specification.

TORQUE

Rear Rack Top Screw ⑤:
84 in-lbs (9 N·m)

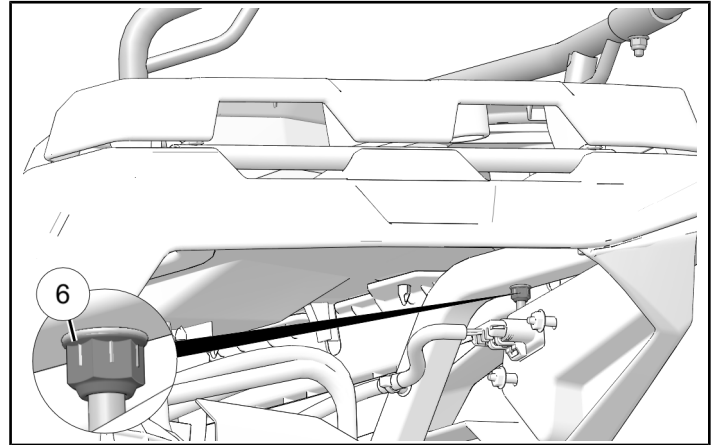

7. Torque rear rack extender assembly screws to specification

TORQUE

Rear Rack Extender Assembly Screw ④:
84 in-lbs (9 N·m)

8. If equipped with dual tail lamps, reinstall the tail light shield on the right side.

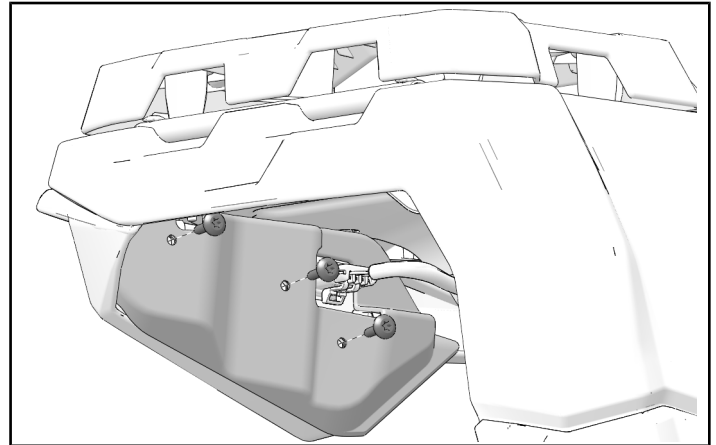

INSTRUCTION FEEDBACK FORM

A feedback form has been created for the installer to provide any comments, questions or concerns about the installation instructions. The form is viewable on mobile devices by scanning the QR code or by clicking [HERE](#) if viewing on a PC.

